

**WHERE THE  
FUTURE LIVES**

New age lifestyle at Coral Bay



**CORAL BAY**

VILLAS

**mox**  
VILLAS & APARTMENTS





The more close we get to nature, the pleasure of life gets more meaningful. Mox is one such company where we come close to nature and find a way to attract our clients to the path of nature and find a deeper sense of design and struture that we create. With great exposure and experience we have empowered the need to demand and produce a denouement by introducing new features and innovative methods to arrange materials to form a structure that very well goes hand in hand with the ecosystem.



# CORAL BAY

VILLAS

Ideally located at Muppathadam, Kalamassery , equidistant from Kochi and Aluva

---

Pristine neighbourhood with abundance of greenery and fresh air

---

Perfect investment value with affordable price with huge potential for value appreciation because of increasing land value

---

Privacy with advantage gated community

---

Choice of unit and plot sizes

---

Design Innovation and spatial integration

---

1.20 Acres

Coral Bay rests in one of the prime locations in Aluva which fills luxury itself to the brim. The landmark pulls up the formidable stature of West 9 as such. Putting up in simple words we can call Coral Bay as the providence of luxury. We have technically made a new approach to our structure making it true to itself. Comprehending our strategy to make it simple but elegantly luxurious and also to manage the transparency with nature is a way of blending altogether a perfect plan that got executed through Coral Bay.



**Creating An Aesthetic Beauty Out Of Bricks**

# DESIGN RESEARCH

Material, Texture and Patterns



Courtyards



Built in Seating



Concrete



Terracotta Jali

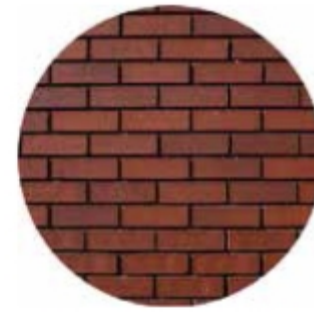

Brick



Wood



Kadappa Stone



Villa 1

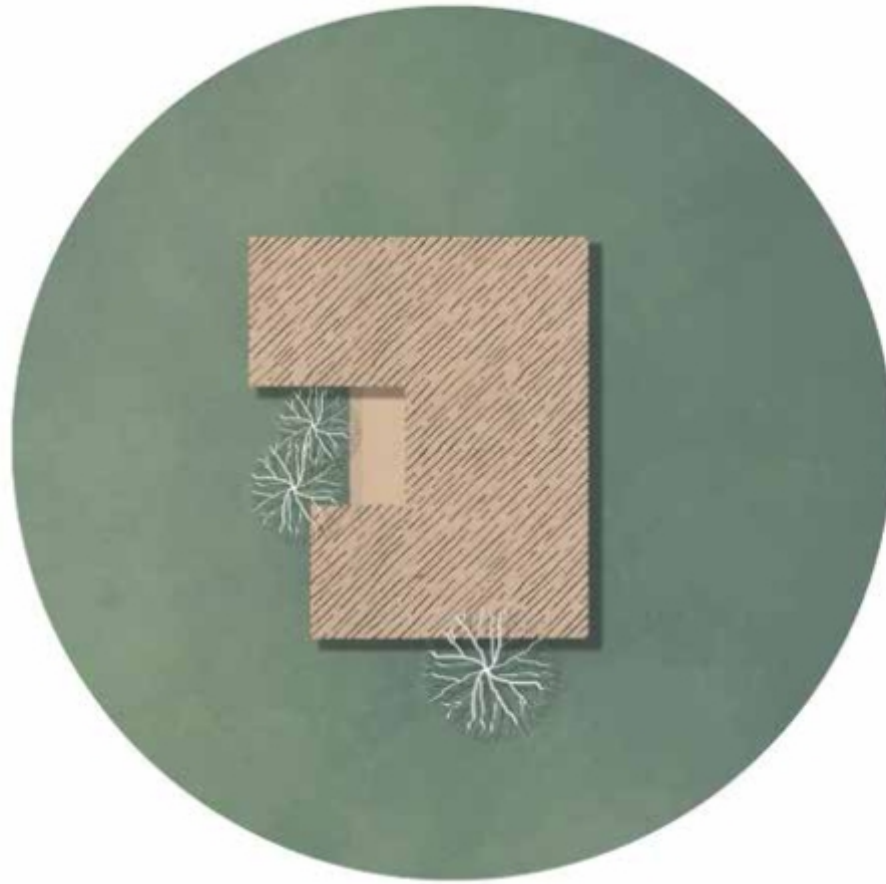

## DESIGN EVOLUTION

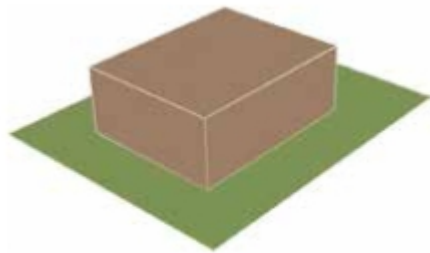

Building mass marked out by providing setbacks.

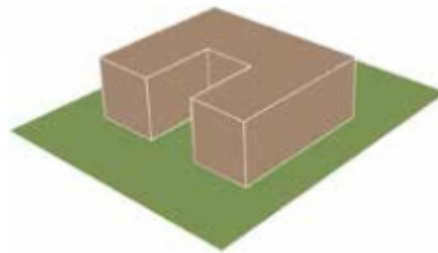

Building oriented towards the courtyard and placed according to the direction of wind.

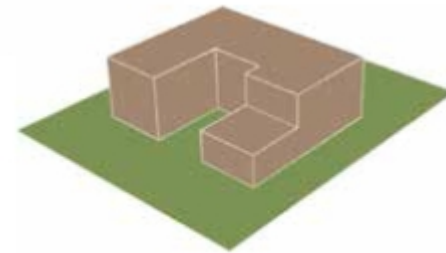

NW corner is subtracted to incorporate a terrace and parking provided at SW corner.











Villa 2

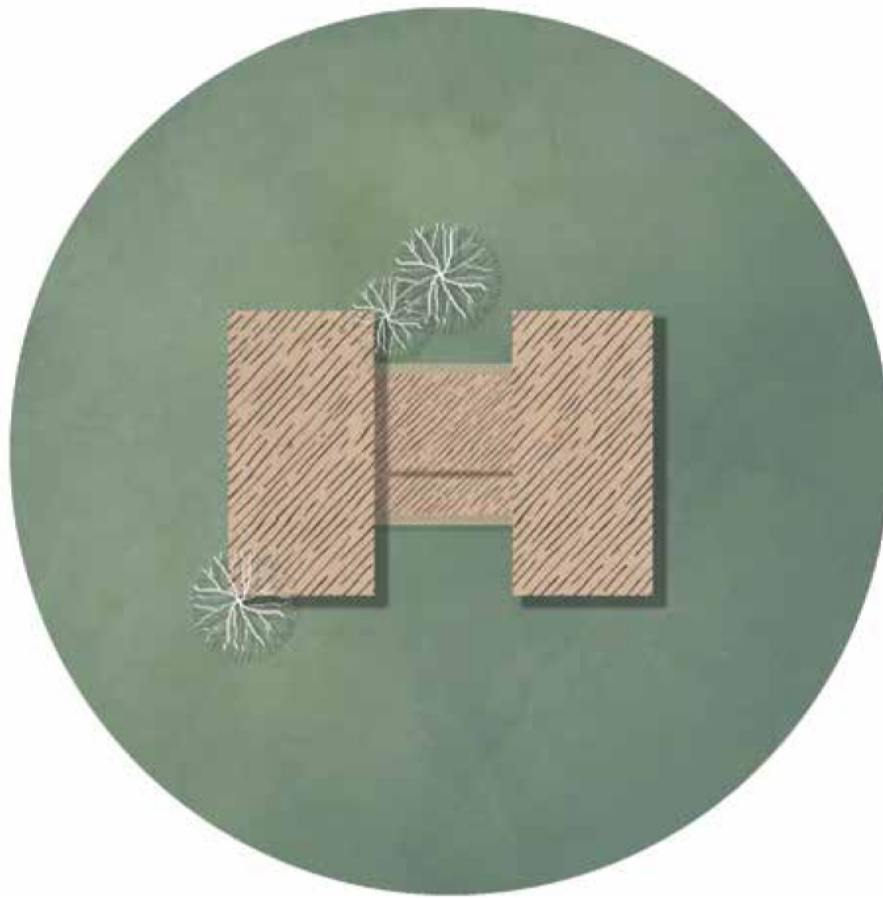

## DESIGN EVOLUTION

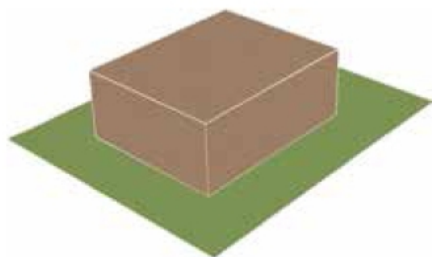

Single solid mass placed by providing setbacks.

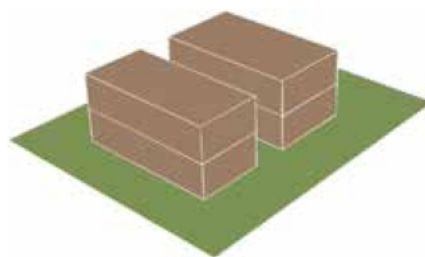

Building is split into two and shifted to incorporate green spaces.

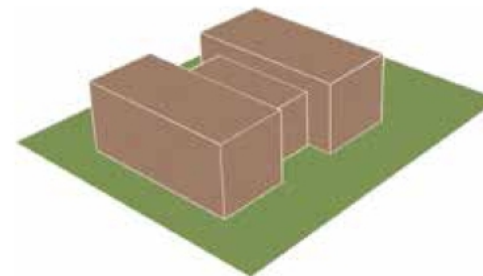

All spaces are arranged based on its priority and design is climatically responsive.







## Concrete Texture

An innovative mastery in bringing materials as raw as they appears from outside. Concrete texture is one such attempt to prove the aesthetic beauty of the material even when it is not processed. The sophisticated grayness of the concrete material proves to induce more rustic design to the Villa.





## **Terracotta Jali**

A natural technique to induce the play of light and shadow is to build a terracotta jali screen or wall. This automatically designs your walls as the light shifts from one place to another. The indigenous beauty created by the jali is in fact a Wow factor.

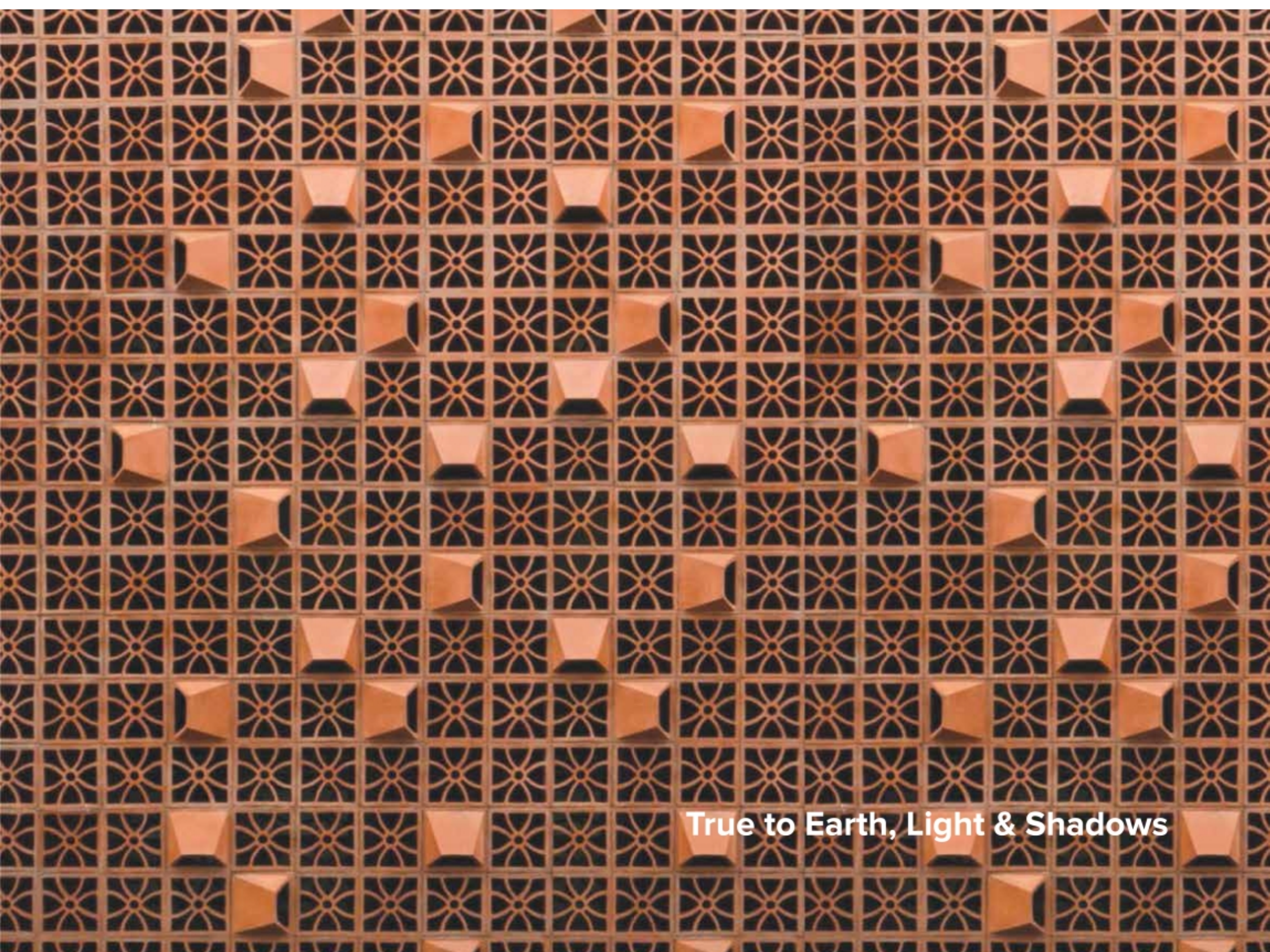

**True to Earth, Light & Shadows**



# STAY TOMORROW READY

A great home is defined as a seamless integration of features to give a very satisfying and fulfilling experience. Coral Bay uses latest spatial design that is about privacy, multi-functional spaces, and minimalist approach with emphasis on quiet elegance. It is a home that that has cozy interiors, a very fresh environment all round, thoughtful amenities and green open spaces -just the right place for a happy living for every age group in the family.

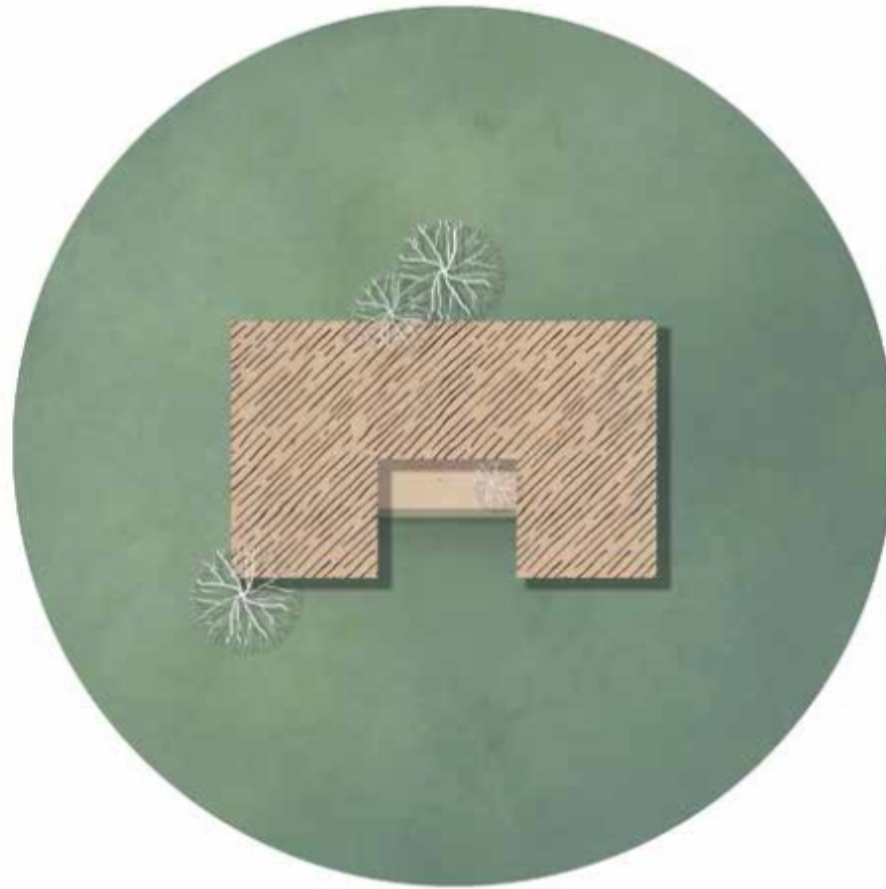

## DESIGN EVOLUTION

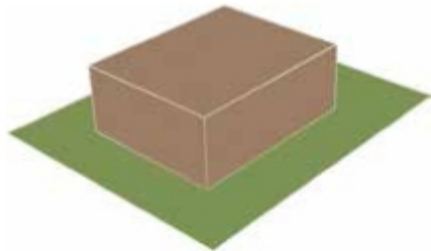

Site is linear and Building mass oriented towards the entrance.

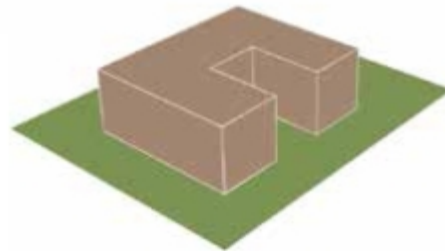

Central portion subtracted to develop a lawn and to facilitate cross ventilation.

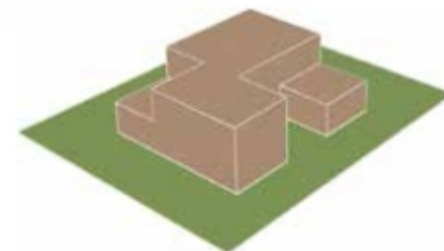

All levels designed with respect to visual connectivity.



**mox**  
VILLAS & APPARTMENTS





## **WOOD**

Wood is associated with tradition and luxury and is an age-old concept that we still follow in design. Wood is something that gets classy and elegant even as time passes. The purity of the earth is visible in wood, and we have tried to bring in this effect in our villas.



**Wood Holds Simplicity & Luxury Together**





### **100% Renewable Energy**

We aim to create self-sustainable and energy-efficient homes. By installing solar panels on the rooftop of every house which creates almost 100% energy for a home, we are making the house's energy sustainable. As we are making the activity space with 40% of the total area in the ground, the rooftop can be used fully for solar panels. Connected to a KSEB grid, the electricity supply will be continuous, eliminating any worry of huge electricity bills.



## Smart Homes

MOX is always one step advanced in technology; in Coral Bay we proudly have administrated IOT system. Premium features are also tailored for ease-of-living which include door sensors, automated gates, video-viewing and limitless possibilities. We leap into futuristic technology using automated homes. Your safty is our responsibility, and we have taken full precautions to safeguard you.



## INFRA FUTURA

First floor, Incuspaze, Thrikkakara, Kakkanad

Mob: 8086094949

Email: [enquirmoxprojects@gmail.com](mailto:enquirmoxprojects@gmail.com)